

# Air Quality Compliance Calendar for Dry Cleaning Facilities in Lane County, Oregon 2022



**LRAPA**  
Lane Regional Air Protection Agency

**LRAPA's Mission:**

To protect public health, quality of life and the environment as a leader and advocate for the continuous improvement of air quality in Lane County.

Lane Regional Air Protection Agency (LRAPA)  
1010 Main Street  
Springfield, OR 97477  
Phone: 541-736-1056 or 877-285-7272  
Fax: 541-726-1205

# Introduction

The State of Oregon, the Oregon Department of Environmental Quality (DEQ), and the Lane Regional Air Protection Agency (LRAPA) have developed this calendar for use by Oregon dry cleaner facilities to assist in compliance with all requirements. This calendar provides general information and tools. Please note that official and full language of all applicable LRAPA Rules and Regulations and permit conditions are the actual enforceable language. A copy of your registration should always be available on site.

Use this link to view LRAPA Title 34:

<https://www.lrapa.org/DocumentCenter/View/261/Title-34-PDF?bidId=>

Use this link to view LRAPA Title 37:

<https://www.lrapa.org/DocumentCenter/View/266/Title-37-PDF?bidId=>

Use this link to view LRAPA Title 37, Table 1:

<https://www.lrapa.org/DocumentCenter/View/264/Title-37---Table-1-PDF?bidId=>

Use this link to view LRAPA Title 37, Table 2:

<https://www.lrapa.org/DocumentCenter/View/265/Title-37---Table-2-PDF?bidId=>

Use this link to view LRAPA Title 37, Table 3:

<https://www.lrapa.org/DocumentCenter/View/4146/Title-37-Table-3>

Use this link to access LRAPA Forms:

<https://www.lrapa.org/163/Air-Contaminant-Discharge-Permit-ACDPs-F>

Use this link to access the 2022 calendar:

<https://www.lrapa.org/DocumentCenter/View/6051/2022-LRAPA-Dry-Cleaners-Calendar>

The following information is from DEQ Hazardous Waste Department for your information and use along with the LRAPA Air quality information provided.

Dear Dry Cleaner,

Welcome to 2022! I hope it will be a good year for you, your family, and your business. This calendar is designed to help you comply with LRAPA and DEQ requirements, and to keep perc from impacting the health of your employees, your neighbors, and the environment. There are some common violations that LRAPA and DEQ finds when inspecting perc dry cleaners. Are you making any of these mistakes? Check now to avoid hassles and fines in case you get inspected this year.

### Leak Checks

Use your leak detector, do a careful check each week, and mark the results in this calendar. If you get a “beep”, investigate- is there a gasket going bad? A leaky connection? Walk outside before you turn on your leak detector, so it calibrates in clean air.



### Records

Keep records on site at your place of business for 5 years, including compliance calendars, perc purchase receipts, hazardous waste disposal records, and repair records.

### Hazardous Waste

Is your hazardous waste drum labeled with the accumulation start date, the first date when waste was put into that drum? Waste can be kept on site up to 1 year. You can request an extension from DEQ for up to 1 more year, by emailing DEQ at [drycleanerinfo@deq.state.or.us](mailto:drycleanerinfo@deq.state.or.us).



### Secondary Containment

Hazardous waste drums and wastewater treatment units must have secondary containment that will hold 110% of the volume of the container.

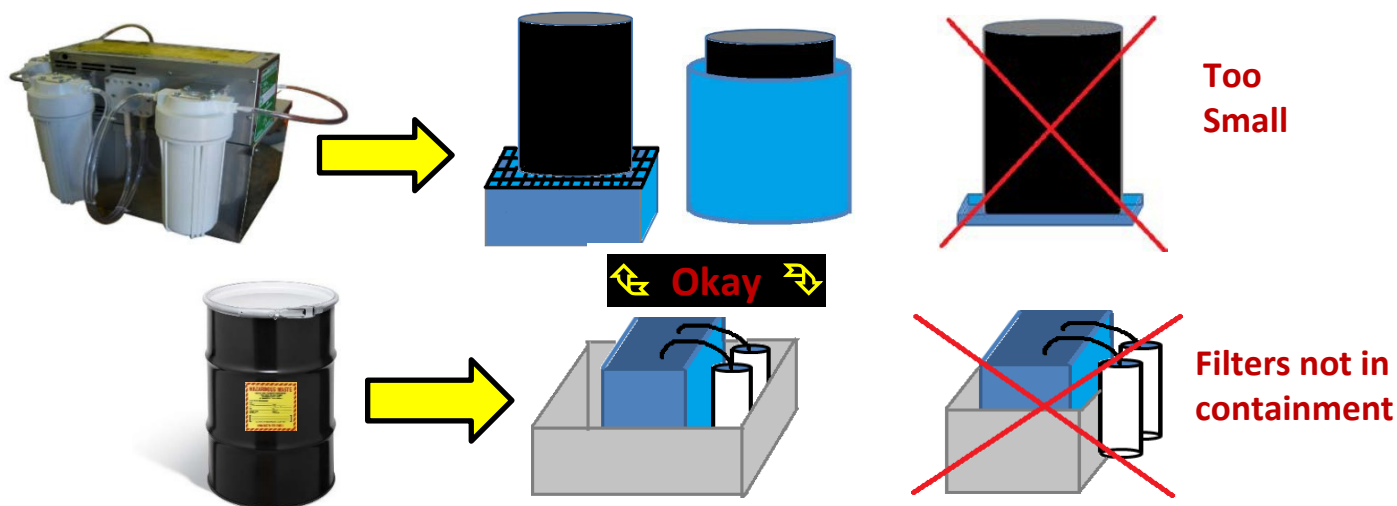

Want more details? A copy of your Air Quality permit conditions is included at the end of this calendar. Also, don't forget that your annual report, fee return and fee payment must be received by LRAPA on or before **March 1st, 2022**. If you have any questions, please contact us at [permitting@lrapa.org](mailto:permitting@lrapa.org) or 541-736-1056.

<b>Leak Detection</b>					
Conduct leak inspection tests <b>weekly</b> on all parts of the equipment.	1. Enter date of the inspections 2. Check equipment, circle "Y" if a leak is detected, "N" if a leak is not detected.				
Enter inspection date					
Hoses	Y N	Y N	Y N	Y N	Y N
Pipe connections	Y N	Y N	Y N	Y N	Y N
Fittings, couplings, and valves	Y N	Y N	Y N	Y N	Y N
Door gasket and seating	Y N	Y N	Y N	Y N	Y N
Pump	Y N	Y N	Y N	Y N	Y N
Solvent tank and containers	Y N	Y N	Y N	Y N	Y N
Water Separator	Y N	Y N	Y N	Y N	Y N
Still/distillation	Y N	Y N	Y N	Y N	Y N
Exhaust damper	Y N	Y N	Y N	Y N	Y N
Diverter valve	Y N	Y N	Y N	Y N	Y N
Filter gasket and seating	Y N	Y N	Y N	Y N	Y N
All machine filters	Y N	Y N	Y N	Y N	Y N
Sealed waste containers ( <i>wastewater, filters, lint, still bottoms</i> )	Y N	Y N	Y N	Y N	Y N
<b>Repair leaks within 24 hours of detection.</b> If parts are required for repair, order within two days, and complete installation within 5 days.					
Parts ordered: Enter date					
Parts received: Enter date					
Repair Complete: Enter date					

<b>Condenser Temperature</b>	
Enter outlet temperature <b>weekly</b> during cool down (should be less than 45°F or 7°C)	
Date	Outlet Temperature

<b>Hazardous Waste</b>		
Enter waste generated <b>monthly</b>		
Cartridge filters replaced		# of filters
Still bottoms generated		pounds
Lint, wastewater filters		pounds
Wastewater evaporated and/or collected in bucket		gallons
Wastewater treatment unit filter changed ( <i>enter date</i> )		
Carbon Adsorbers ( <i>enter dates</i> CA Desorbed)		
<b>Waste Containers Labeled &amp; Dated?</b>	Y	N
<b>Containment equipment inspected?</b> <i>Dry cleaning machine pan seal, wastewater treatment unit, waste containers, and new solvent</i>	Y	N
<b>PERC Purchases</b>		
Date:	Date:	
Gallons:	Gallons:	

**January 2022**

Sunday	Monday	Tuesday	Wednesday	Thursday	Friday	Saturday
<b>2021 Annual Report, 2022 Fee Return with payment, and Air Quality fees must be received by LRAPA by Monday, March 1, 2022.</b>						
						1
2	3	4	5	6	7	8
					<input type="checkbox"/> Temp logged <input type="checkbox"/> Inspect logged	
9	10	11	12	13	14	15
					<input type="checkbox"/> Temp logged <input type="checkbox"/> Inspect logged	
16	17	18	19	20	21	22
					<input type="checkbox"/> Temp logged <input type="checkbox"/> Inspect logged	
23	24	25	26	27	28	29
					<input type="checkbox"/> Temp logged <input type="checkbox"/> Inspect logged	
30	31					

Leak Detection					
Conduct leak inspection tests <b>weekly</b> on all parts of the equipment.	1. Enter date of the inspections 2. Check equipment, circle "Y" if a leak is detected, "N" if a leak is not detected.				
Enter inspection date					
Hoses	Y N	Y N	Y N	Y N	Y N
Pipe connections	Y N	Y N	Y N	Y N	Y N
Fittings, couplings, and valves	Y N	Y N	Y N	Y N	Y N
Door gasket and seating	Y N	Y N	Y N	Y N	Y N
Pump	Y N	Y N	Y N	Y N	Y N
Solvent tank and containers	Y N	Y N	Y N	Y N	Y N
Water Separator	Y N	Y N	Y N	Y N	Y N
Still/distillation	Y N	Y N	Y N	Y N	Y N
Exhaust damper	Y N	Y N	Y N	Y N	Y N
Diverter valve	Y N	Y N	Y N	Y N	Y N
Filter gasket and seating	Y N	Y N	Y N	Y N	Y N
All machine filters	Y N	Y N	Y N	Y N	Y N
Sealed waste containers (wastewater, filters, lint, still bottoms)	Y N	Y N	Y N	Y N	Y N
<b>Repair leaks within 24 hours of detection.</b> If parts are required for repair, order within two days, and complete installation within 5 days.					
Parts ordered: Enter date					
Parts received: Enter date					
Repair Complete: Enter date					

Condenser Temperature	
Enter outlet temperature <b>weekly</b> during cool down (should be less than 45°F or 7°C)	
Date	Outlet Temperature

Hazardous Waste		
Enter waste generated <b>monthly</b>		
Cartridge filters replaced		# of filters
Still bottoms generated		pounds
Lint, wastewater filters		pounds
Wastewater evaporated and/or collected in bucket		gallons
Wastewater treatment unit filter changed (enter date)		
Carbon Adsorbers (enter dates CA Desorbed)		
Waste Containers Labeled & Dated?		Y N
Containment equipment inspected? Dry cleaning machine pan seal, wastewater treatment unit, waste containers, and new solvent		Y N
PERC Purchases		
Date:	Date:	
Gallons:	Gallons:	

**February 2022**

Sunday	Monday	Tuesday	Wednesday	Thursday	Friday	Saturday
<b>2021 Annual Report, 2022 Fee Return with payment, and Air Quality fees must be received by LRAPA by Monday, March 1, 2022.</b>						
		1	2	3	4 <input type="checkbox"/> Temp logged <input type="checkbox"/> Inspect logged	5
6	7	8	9	10	11 <input type="checkbox"/> Temp logged <input type="checkbox"/> Inspect logged	12
13	14	15	16	17	18 <input type="checkbox"/> Temp logged <input type="checkbox"/> Inspect logged	19
20	21	22	23	24	25 <input type="checkbox"/> Temp logged <input type="checkbox"/> Inspect logged	26
27	28					

Leak Detection					
Conduct leak inspection tests <b>weekly</b> on all parts of the equipment.	1. Enter date of the inspections 2. Check equipment, circle "Y" if a leak is detected, "N" if a leak is not detected.				
Enter inspection date					
Hoses	Y N	Y N	Y N	Y N	Y N
Pipe connections	Y N	Y N	Y N	Y N	Y N
Fittings, couplings, and valves	Y N	Y N	Y N	Y N	Y N
Door gasket and seating	Y N	Y N	Y N	Y N	Y N
Pump	Y N	Y N	Y N	Y N	Y N
Solvent tank and containers	Y N	Y N	Y N	Y N	Y N
Water Separator	Y N	Y N	Y N	Y N	Y N
Still/distillation	Y N	Y N	Y N	Y N	Y N
Exhaust damper	Y N	Y N	Y N	Y N	Y N
Diverter valve	Y N	Y N	Y N	Y N	Y N
Filter gasket and seating	Y N	Y N	Y N	Y N	Y N
All machine filters	Y N	Y N	Y N	Y N	Y N
Sealed waste containers (wastewater, filters, lint, still bottoms)	Y N	Y N	Y N	Y N	Y N
<b>Repair leaks within 24 hours of detection.</b> If parts are required for repair, order within two days, and complete installation within 5 days.					
Parts ordered: Enter date					
Parts received: Enter date					
Repair Complete: Enter date					

Condenser Temperature	
Enter outlet temperature <b>weekly</b> during cool down (should be less than 45°F or 7°C)	
Date	Outlet Temperature

Hazardous Waste		
Enter waste generated <b>monthly</b>		
Cartridge filters replaced		# of filters
Still bottoms generated		pounds
Lint, wastewater filters		pounds
Wastewater evaporated and/or collected in bucket		gallons
Wastewater treatment unit filter changed (enter date)		
Carbon Adsorbers (enter dates CA Desorbed)		

Waste Containers Labeled & Dated?	Y	N
Containment equipment inspected? Dry cleaning machine pan seal, wastewater treatment unit, waste containers, and new solvent	Y	N

PERC Purchases	
Date:	Date:
Gallons:	Gallons:

**March 2022**

Sunday	Monday	Tuesday	Wednesday	Thursday	Friday	Saturday
<b>2021 Annual Report, 2022 Fee Return with payment, and Air Quality fees must be received by LRAPA by Monday, March 1, 2022.</b>						
		<b>1</b> <b>DUE:</b> <input type="checkbox"/> Annual Report <input type="checkbox"/> Annual Fee	<b>2</b>	<b>3</b>	<b>4</b> <input type="checkbox"/> Temp logged <input type="checkbox"/> Inspect logged	<b>5</b>
<b>6</b>	<b>7</b>	<b>8</b>	<b>9</b>	<b>10</b>	<b>11</b> <input type="checkbox"/> Temp logged <input type="checkbox"/> Inspect logged	<b>12</b>
<b>13</b>	<b>14</b>	<b>15</b>	<b>16</b>	<b>17</b>	<b>18</b> <input type="checkbox"/> Temp logged <input type="checkbox"/> Inspect logged	<b>19</b>
<b>20</b>	<b>21</b>	<b>22</b>	<b>23</b>	<b>24</b>	<b>25</b> <input type="checkbox"/> Temp logged <input type="checkbox"/> Inspect logged	<b>26</b>
<b>27</b>	<b>28</b>	<b>29</b>	<b>30</b>	<b>31</b>		

<b>Leak Detection</b>					
Conduct leak inspection tests <b>weekly</b> on all parts of the equipment.	1. Enter date of the inspections 2. Check equipment, circle "Y" if a leak is detected, "N" if a leak is not detected.				
Enter inspection date					
Hoses	Y N	Y N	Y N	Y N	Y N
Pipe connections	Y N	Y N	Y N	Y N	Y N
Fittings, couplings, and valves	Y N	Y N	Y N	Y N	Y N
Door gasket and seating	Y N	Y N	Y N	Y N	Y N
Pump	Y N	Y N	Y N	Y N	Y N
Solvent tank and containers	Y N	Y N	Y N	Y N	Y N
Water Separator	Y N	Y N	Y N	Y N	Y N
Still/distillation	Y N	Y N	Y N	Y N	Y N
Exhaust damper	Y N	Y N	Y N	Y N	Y N
Diverter valve	Y N	Y N	Y N	Y N	Y N
Filter gasket and seating	Y N	Y N	Y N	Y N	Y N
All machine filters	Y N	Y N	Y N	Y N	Y N
Sealed waste containers ( <i>wastewater, filters, lint, still bottoms</i> )	Y N	Y N	Y N	Y N	Y N
<b>Repair leaks within 24 hours of detection.</b> If parts are required for repair, order within two days, and complete installation within 5 days.					
Parts ordered: Enter date					
Parts received: Enter date					
Repair Complete: Enter date					

<b>Condenser Temperature</b>	
Enter outlet temperature <b>weekly</b> during cool down (should be less than 45°F or 7°C)	
Date	Outlet Temperature

<b>Hazardous Waste</b>		
Enter waste generated <b>monthly</b>		
Cartridge filters replaced		# of filters
Still bottoms generated		pounds
Lint, wastewater filters		pounds
Wastewater evaporated and/or collected in bucket		gallons
Wastewater treatment unit filter changed ( <i>enter date</i> )		
Carbon Adsorbers ( <i>enter dates</i> CA Desorbed)		
<b>Waste Containers Labeled &amp; Dated?</b>	Y	N
<b>Containment equipment inspected?</b> <i>Dry cleaning machine pan seal, wastewater treatment unit, waste containers, and new solvent</i>	Y	N
<b>PERC Purchases</b>		
Date:	Date:	
Gallons:	Gallons:	

**April 2022**

Sunday	Monday	Tuesday	Wednesday	Thursday	Friday	Saturday
					1 <input type="checkbox"/> Temp logged <input type="checkbox"/> Inspect logged	2
3	4	5	6	7	8 <input type="checkbox"/> Temp logged <input type="checkbox"/> Inspect logged	9
10	11	12	13	14	15 <input type="checkbox"/> Temp logged <input type="checkbox"/> Inspect logged	16
17	18	19	20	21	22 <input type="checkbox"/> Temp logged <input type="checkbox"/> Inspect logged	23
24	25	26	27	28	29 <input type="checkbox"/> Temp logged <input type="checkbox"/> Inspect logged	30

<b>Leak Detection</b>					
Conduct leak inspection tests <b>weekly</b> on all parts of the equipment.	1. Enter date of the inspections 2. Check equipment, circle "Y" if a leak is detected, "N" if a leak is not detected.				
Enter inspection date					
Hoses	Y N	Y N	Y N	Y N	Y N
Pipe connections	Y N	Y N	Y N	Y N	Y N
Fittings, couplings, and valves	Y N	Y N	Y N	Y N	Y N
Door gasket and seating	Y N	Y N	Y N	Y N	Y N
Pump	Y N	Y N	Y N	Y N	Y N
Solvent tank and containers	Y N	Y N	Y N	Y N	Y N
Water Separator	Y N	Y N	Y N	Y N	Y N
Still/distillation	Y N	Y N	Y N	Y N	Y N
Exhaust damper	Y N	Y N	Y N	Y N	Y N
Diverter valve	Y N	Y N	Y N	Y N	Y N
Filter gasket and seating	Y N	Y N	Y N	Y N	Y N
All machine filters	Y N	Y N	Y N	Y N	Y N
Sealed waste containers ( <i>wastewater, filters, lint, still bottoms</i> )	Y N	Y N	Y N	Y N	Y N
<b>Repair leaks within 24 hours of detection.</b> If parts are required for repair, order within two days, and complete installation within 5 days.					
Parts ordered: Enter date					
Parts received: Enter date					
Repair Complete: Enter date					

<b>Condenser Temperature</b>	
Enter outlet temperature <b>weekly</b> during cool down (should be less than 45°F or 7°C)	
Date	Outlet Temperature

<b>Hazardous Waste</b>		
Enter waste generated <b>monthly</b>		
Cartridge filters replaced		# of filters
Still bottoms generated		pounds
Lint, wastewater filters		pounds
Wastewater evaporated and/or collected in bucket		gallons
Wastewater treatment unit filter changed ( <i>enter date</i> )		
Carbon Adsorbers ( <i>enter dates</i> CA Desorbed)		

Waste Containers Labeled & Dated?	Y	N
Containment equipment inspected? ( <i>Dry cleaning machine pan seal, wastewater treatment unit, waste containers, and new solvent</i> )	Y	N

<b>PERC Purchases</b>	
Date:	Date:
Gallons:	Gallons:

**May 2022**

Sunday	Monday	Tuesday	Wednesday	Thursday	Friday	Saturday
1	2	3	4	5	6 <input type="checkbox"/> Temp logged <input type="checkbox"/> Inspect logged	7
8	9	10	11	12	13 <input type="checkbox"/> Temp logged <input type="checkbox"/> Inspect logged	14
15	16	17	18	19	20 <input type="checkbox"/> Temp logged <input type="checkbox"/> Inspect logged	21
22	23	24	25	26	27 <input type="checkbox"/> Temp logged <input type="checkbox"/> Inspect logged	28
29	30	31				



Leak Detection					
Conduct leak inspection tests <b>weekly</b> on all parts of the equipment.	1. Enter date of the inspections 2. Check equipment, circle "Y" if a leak is detected, "N" if a leak is not detected.				
Enter inspection date					
Hoses	Y N	Y N	Y N	Y N	Y N
Pipe connections	Y N	Y N	Y N	Y N	Y N
Fittings, couplings, and valves	Y N	Y N	Y N	Y N	Y N
Door gasket and seating	Y N	Y N	Y N	Y N	Y N
Pump	Y N	Y N	Y N	Y N	Y N
Solvent tank and containers	Y N	Y N	Y N	Y N	Y N
Water Separator	Y N	Y N	Y N	Y N	Y N
Still/distillation	Y N	Y N	Y N	Y N	Y N
Exhaust damper	Y N	Y N	Y N	Y N	Y N
Diverter valve	Y N	Y N	Y N	Y N	Y N
Filter gasket and seating	Y N	Y N	Y N	Y N	Y N
All machine filters	Y N	Y N	Y N	Y N	Y N
Sealed waste containers ( <i>wastewater, filters, lint, still bottoms</i> )	Y N	Y N	Y N	Y N	Y N
<b>Repair leaks within 24 hours of detection.</b> If parts are required for repair, order within two days, and complete installation within 5 days.					
Parts ordered: Enter date					
Parts received: Enter date					
Repair Complete: Enter date					

Condenser Temperature	
Enter outlet temperature <b>weekly</b> during cool down (should be less than 45°F or 7°C)	
Date	Outlet Temperature

Hazardous Waste		
Enter waste generated <b>monthly</b>		
Cartridge filters replaced		# of filters
Still bottoms generated		pounds
Lint, wastewater filters		pounds
Wastewater evaporated and/or collected in bucket		gallons
Wastewater treatment unit filter changed ( <i>enter date</i> )		
Carbon Adsorbers ( <i>enter dates</i> CA Desorbed)		
<b>Waste Containers Labeled &amp; Dated?</b>	Y	N
<b>Containment equipment inspected?</b> <i>Dry cleaning machine pan seal, wastewater treatment unit, waste containers, and new solvent</i>	Y	N
PERC Purchases		
Date:	Date:	
Gallons:	Gallons:	

**June 2022**

Sunday	Monday	Tuesday	Wednesday	Thursday	Friday	Saturday
			1	2	3 <input type="checkbox"/> Temp logged <input type="checkbox"/> Inspect logged	4
5	6	7	8	9	10 <input type="checkbox"/> Temp logged <input type="checkbox"/> Inspect logged	11
12	13	14	15	16	17 <input type="checkbox"/> Temp logged <input type="checkbox"/> Inspect logged	18
19	20	21	22	23	24 <input type="checkbox"/> Temp logged <input type="checkbox"/> Inspect logged	25
26	27	28	29	30		

<b>Leak Detection</b>					
Conduct leak inspection tests <b>weekly</b> on all parts of the equipment.	1. Enter date of the inspections 2. Check equipment, circle "Y" if a leak is detected, "N" if a leak is not detected.				
Enter inspection date					
Hoses	Y N	Y N	Y N	Y N	Y N
Pipe connections	Y N	Y N	Y N	Y N	Y N
Fittings, couplings, and valves	Y N	Y N	Y N	Y N	Y N
Door gasket and seating	Y N	Y N	Y N	Y N	Y N
Pump	Y N	Y N	Y N	Y N	Y N
Solvent tank and containers	Y N	Y N	Y N	Y N	Y N
Water Separator	Y N	Y N	Y N	Y N	Y N
Still/distillation	Y N	Y N	Y N	Y N	Y N
Exhaust damper	Y N	Y N	Y N	Y N	Y N
Diverter valve	Y N	Y N	Y N	Y N	Y N
Filter gasket and seating	Y N	Y N	Y N	Y N	Y N
All machine filters	Y N	Y N	Y N	Y N	Y N
Sealed waste containers (wastewater, filters, lint, still bottoms)	Y N	Y N	Y N	Y N	Y N
<b>Repair leaks within 24 hours of detection.</b> If parts are required for repair, order within two days, and complete installation within 5 days.					
Parts ordered: Enter date					
Parts received: Enter date					
Repair Complete: Enter date					

<b>Condenser Temperature</b>	
Enter outlet temperature <b>weekly</b> during cool down (should be less than 45°F or 7°C)	
Date	Outlet Temperature

<b>Hazardous Waste</b>		
Enter waste generated <b>monthly</b>		
Cartridge filters replaced		# of filters
Still bottoms generated		pounds
Lint, wastewater filters		pounds
Wastewater evaporated and/or collected in bucket		gallons
Wastewater treatment unit filter changed (enter date)		
Carbon Adsorbers (enter dates CA Desorbed)		

Waste Containers Labeled & Dated?	Y	N
Containment equipment inspected? Dry cleaning machine pan seal, wastewater treatment unit, waste containers, and new solvent	Y	N

<b>PERC Purchases</b>	
Date:	Date:
Gallons:	Gallons:

**July 2022**

Sunday	Monday	Tuesday	Wednesday	Thursday	Friday	Saturday
					1 <input type="checkbox"/> Temp logged <input type="checkbox"/> Inspect logged	2
3	4	5	6	7	8 <input type="checkbox"/> Temp logged <input type="checkbox"/> Inspect logged	9
10	11	12	13	14	15 <input type="checkbox"/> Temp logged <input type="checkbox"/> Inspect logged	16
17	18	19	20	21	22 <input type="checkbox"/> Temp logged <input type="checkbox"/> Inspect logged	23
24 31	25	26	27	28	29 <input type="checkbox"/> Temp logged <input type="checkbox"/> Inspect logged	30

<b>Leak Detection</b>					
Conduct leak inspection tests <b>weekly</b> on all parts of the equipment.	1. Enter date of the inspections 2. Check equipment, circle "Y" if a leak is detected, "N" if a leak is not detected.				
Enter inspection date					
Hoses	Y N	Y N	Y N	Y N	Y N
Pipe connections	Y N	Y N	Y N	Y N	Y N
Fittings, couplings, and valves	Y N	Y N	Y N	Y N	Y N
Door gasket and seating	Y N	Y N	Y N	Y N	Y N
Pump	Y N	Y N	Y N	Y N	Y N
Solvent tank and containers	Y N	Y N	Y N	Y N	Y N
Water Separator	Y N	Y N	Y N	Y N	Y N
Still/distillation	Y N	Y N	Y N	Y N	Y N
Exhaust damper	Y N	Y N	Y N	Y N	Y N
Diverter valve	Y N	Y N	Y N	Y N	Y N
Filter gasket and seating	Y N	Y N	Y N	Y N	Y N
All machine filters	Y N	Y N	Y N	Y N	Y N
Sealed waste containers ( <i>wastewater, filters, lint, still bottoms</i> )	Y N	Y N	Y N	Y N	Y N
<b>Repair leaks within 24 hours of detection.</b> If parts are required for repair, order within two days, and complete installation within 5 days.					
Parts ordered: Enter date					
Parts received: Enter date					
Repair Complete: Enter date					

<b>Condenser Temperature</b>	
Enter outlet temperature <b>weekly</b> during cool down (should be less than 45°F or 7°C)	
Date	Outlet Temperature

<b>Hazardous Waste</b>		
Enter waste generated <b>monthly</b>		
Cartridge filters replaced		# of filters
Still bottoms generated		pounds
Lint, wastewater filters		pounds
Wastewater evaporated and/or collected in bucket		gallons
Wastewater treatment unit filter changed ( <i>enter date</i> )		
Carbon Adsorbers ( <i>enter dates</i> CA Desorbed)		

Waste Containers Labeled & Dated?	Y	N
Containment equipment inspected? ( <i>Dry cleaning machine pan seal, wastewater treatment unit, waste containers, and new solvent</i> )	Y	N

<b>PERC Purchases</b>	
Date:	Date:
Gallons:	Gallons:

**August 2022**

Sunday	Monday	Tuesday	Wednesday	Thursday	Friday	Saturday
	1	2	3	4	5 <input type="checkbox"/> Temp logged <input type="checkbox"/> Inspect logged	6
7	8	9	10	11	12 <input type="checkbox"/> Temp logged <input type="checkbox"/> Inspect logged	13
14	15	16	17	18	19 <input type="checkbox"/> Temp logged <input type="checkbox"/> Inspect logged	20
21	22	23	24	25	26 <input type="checkbox"/> Temp logged <input type="checkbox"/> Inspect logged	27
28	29	30	31			

Leak Detection					
Conduct leak inspection tests <b>weekly</b> on all parts of the equipment.	1. Enter date of the inspections 2. Check equipment, circle "Y" if a leak is detected, "N" if a leak is not detected.				
Enter inspection date					
Hoses	Y N	Y N	Y N	Y N	Y N
Pipe connections	Y N	Y N	Y N	Y N	Y N
Fittings, couplings, and valves	Y N	Y N	Y N	Y N	Y N
Door gasket and seating	Y N	Y N	Y N	Y N	Y N
Pump	Y N	Y N	Y N	Y N	Y N
Solvent tank and containers	Y N	Y N	Y N	Y N	Y N
Water Separator	Y N	Y N	Y N	Y N	Y N
Still/distillation	Y N	Y N	Y N	Y N	Y N
Exhaust damper	Y N	Y N	Y N	Y N	Y N
Diverter valve	Y N	Y N	Y N	Y N	Y N
Filter gasket and seating	Y N	Y N	Y N	Y N	Y N
All machine filters	Y N	Y N	Y N	Y N	Y N
Sealed waste containers ( <i>wastewater, filters, lint, still bottoms</i> )	Y N	Y N	Y N	Y N	Y N
<b>Repair leaks within 24 hours of detection.</b> If parts are required for repair, order within two days, and complete installation within 5 days.					
Parts ordered: Enter date					
Parts received: Enter date					
Repair Complete: Enter date					

Condenser Temperature	
Enter outlet temperature <b>weekly</b> during cool down (should be less than 45°F or 7°C)	
Date	Outlet Temperature

Hazardous Waste		
Enter waste generated <b>monthly</b>		
Cartridge filters replaced		# of filters
Still bottoms generated		pounds
Lint, wastewater filters		pounds
Wastewater evaporated and/or collected in bucket		gallons
Wastewater treatment unit filter changed ( <i>enter date</i> )		
Carbon Adsorbers ( <i>enter dates</i> CA Desorbed)		
<b>Waste Containers Labeled &amp; Dated?</b>		Y N
<b>Containment equipment inspected?</b> <i>Dry cleaning machine pan seal, wastewater treatment unit, waste containers, and new solvent</i>		Y N
PERC Purchases		
Date:	Date:	
Gallons:	Gallons:	

**September 2022**

Sunday	Monday	Tuesday	Wednesday	Thursday	Friday	Saturday
				1	2 <input type="checkbox"/> Temp logged <input type="checkbox"/> Inspect logged	3
4	5	6	7	8	9 <input type="checkbox"/> Temp logged <input type="checkbox"/> Inspect logged	10
11	12	13	14	15	16 <input type="checkbox"/> Temp logged <input type="checkbox"/> Inspect logged	17
18	19	20	21	22	23 <input type="checkbox"/> Temp logged <input type="checkbox"/> Inspect logged	24
25	26	27	28	29	30	

<b>Leak Detection</b>					
Conduct leak inspection tests <b>weekly</b> on all parts of the equipment.	1. Enter date of the inspections 2. Check equipment, circle "Y" if a leak is detected, "N" if a leak is not detected.				
Enter inspection date					
Hoses	Y N	Y N	Y N	Y N	Y N
Pipe connections	Y N	Y N	Y N	Y N	Y N
Fittings, couplings, and valves	Y N	Y N	Y N	Y N	Y N
Door gasket and seating	Y N	Y N	Y N	Y N	Y N
Pump	Y N	Y N	Y N	Y N	Y N
Solvent tank and containers	Y N	Y N	Y N	Y N	Y N
Water Separator	Y N	Y N	Y N	Y N	Y N
Still/distillation	Y N	Y N	Y N	Y N	Y N
Exhaust damper	Y N	Y N	Y N	Y N	Y N
Diverter valve	Y N	Y N	Y N	Y N	Y N
Filter gasket and seating	Y N	Y N	Y N	Y N	Y N
All machine filters	Y N	Y N	Y N	Y N	Y N
Sealed waste containers ( <i>wastewater, filters, lint, still bottoms</i> )	Y N	Y N	Y N	Y N	Y N
<b>Repair leaks within 24 hours of detection.</b> If parts are required for repair, order within two days, and complete installation within 5 days.					
Parts ordered: Enter date					
Parts received: Enter date					
Repair Complete: Enter date					

<b>Condenser Temperature</b>	
Enter outlet temperature <b>weekly</b> during cool down (should be less than 45°F or 7°C)	
Date	Outlet Temperature

<b>Hazardous Waste</b>		
Enter waste generated <b>monthly</b>		
Cartridge filters replaced		# of filters
Still bottoms generated		pounds
Lint, wastewater filters		pounds
Wastewater evaporated and/or collected in bucket		gallons
Wastewater treatment unit filter changed ( <i>enter date</i> )		
Carbon Adsorbers ( <i>enter dates</i> CA Desorbed)		
<b>Waste Containers Labeled &amp; Dated?</b>	Y	N
<b>Containment equipment inspected?</b> <i>Dry cleaning machine pan seal, wastewater treatment unit, waste containers, and new solvent</i>	Y	N
<b>PERC Purchases</b>		
Date:		Date:
Gallons:		Gallons:

**October 2022**

Sunday	Monday	Tuesday	Wednesday	Thursday	Friday	Saturday
						1
2	3	4	5	6	7 <input type="checkbox"/> Temp logged <input type="checkbox"/> Inspect logged	8
9	10	11	12	13	14 <input type="checkbox"/> Temp logged <input type="checkbox"/> Inspect logged	15
16	17	18	19	20	21 <input type="checkbox"/> Temp logged <input type="checkbox"/> Inspect logged	22
23	24	25	26	27	28 <input type="checkbox"/> Temp logged <input type="checkbox"/> Inspect logged	29
30	31					

<b>Leak Detection</b>					
Conduct leak inspection tests <b>weekly</b> on all parts of the equipment.	1. Enter date of the inspections 2. Check equipment, circle "Y" if a leak is detected, "N" if a leak is not detected.				
Enter inspection date					
Hoses	Y N	Y N	Y N	Y N	Y N
Pipe connections	Y N	Y N	Y N	Y N	Y N
Fittings, couplings, and valves	Y N	Y N	Y N	Y N	Y N
Door gasket and seating	Y N	Y N	Y N	Y N	Y N
Pump	Y N	Y N	Y N	Y N	Y N
Solvent tank and containers	Y N	Y N	Y N	Y N	Y N
Water Separator	Y N	Y N	Y N	Y N	Y N
Still/distillation	Y N	Y N	Y N	Y N	Y N
Exhaust damper	Y N	Y N	Y N	Y N	Y N
Diverter valve	Y N	Y N	Y N	Y N	Y N
Filter gasket and seating	Y N	Y N	Y N	Y N	Y N
All machine filters	Y N	Y N	Y N	Y N	Y N
Sealed waste containers ( <i>wastewater, filters, lint, still bottoms</i> )	Y N	Y N	Y N	Y N	Y N
<b>Repair leaks within 24 hours of detection.</b> If parts are required for repair, order within two days, and complete installation within 5 days.					
Parts ordered: Enter date					
Parts received: Enter date					
Repair Complete: Enter date					

<b>Condenser Temperature</b>	
Enter outlet temperature <b>weekly</b> during cool down (should be less than 45°F or 7°C)	
Date	Outlet Temperature

<b>Hazardous Waste</b>		
Enter waste generated <b>monthly</b>		
Cartridge filters replaced		# of filters
Still bottoms generated		pounds
Lint, wastewater filters		pounds
Wastewater evaporated and/or collected in bucket		gallons
Wastewater treatment unit filter changed ( <i>enter date</i> )		
Carbon Adsorbers ( <i>enter dates</i> CA Desorbed)		

Waste Containers Labeled & Dated?	Y	N
Containment equipment inspected? ( <i>Dry cleaning machine pan seal, wastewater treatment unit, waste containers, and new solvent</i> )	Y	N

<b>PERC Purchases</b>	
Date:	Date:
Gallons:	Gallons:

**November 2022**

Sunday	Monday	Tuesday	Wednesday	Thursday	Friday	Saturday
		1	2	3	4 <input type="checkbox"/> Temp logged <input type="checkbox"/> Inspect logged	5
6	7	8	9	10	11 <input type="checkbox"/> Temp logged <input type="checkbox"/> Inspect logged	12
13	14	15	16	17	18 <input type="checkbox"/> Temp logged <input type="checkbox"/> Inspect logged	19
20	21	22	23	24	25 <input type="checkbox"/> Temp logged <input type="checkbox"/> Inspect logged	26
27	28	29	30			

<b>Leak Detection</b>					
Conduct leak inspection tests <b>weekly</b> on all parts of the equipment.	1. Enter date of the inspections 2. Check equipment, circle "Y" if a leak is detected, "N" if a leak is not detected.				
Enter inspection date					
Hoses	Y N	Y N	Y N	Y N	Y N
Pipe connections	Y N	Y N	Y N	Y N	Y N
Fittings, couplings, and valves	Y N	Y N	Y N	Y N	Y N
Door gasket and seating	Y N	Y N	Y N	Y N	Y N
Pump	Y N	Y N	Y N	Y N	Y N
Solvent tank and containers	Y N	Y N	Y N	Y N	Y N
Water Separator	Y N	Y N	Y N	Y N	Y N
Still/distillation	Y N	Y N	Y N	Y N	Y N
Exhaust damper	Y N	Y N	Y N	Y N	Y N
Diverter valve	Y N	Y N	Y N	Y N	Y N
Filter gasket and seating	Y N	Y N	Y N	Y N	Y N
All machine filters	Y N	Y N	Y N	Y N	Y N
Sealed waste containers ( <i>wastewater, filters, lint, still bottoms</i> )	Y N	Y N	Y N	Y N	Y N
<b>Repair leaks within 24 hours of detection.</b> If parts are required for repair, order within two days, and complete installation within 5 days.					
Parts ordered: Enter date					
Parts received: Enter date					
Repair Complete: Enter date					

<b>Condenser Temperature</b>	
Enter outlet temperature <b>weekly</b> during cool down (should be less than 45°F or 7°C)	
Date	Outlet Temperature

<b>Hazardous Waste</b>		
Enter waste generated <b>monthly</b>		
Cartridge filters replaced		# of filters
Still bottoms generated		pounds
Lint, wastewater filters		pounds
Wastewater evaporated and/or collected in bucket		gallons
Wastewater treatment unit filter changed ( <i>enter date</i> )		
Carbon Adsorbers ( <i>enter dates</i> CA Desorbed)		

Waste Containers Labeled & Dated?	Y	N
Containment equipment inspected? ( <i>Dry cleaning machine pan seal, wastewater treatment unit, waste containers, and new solvent</i> )	Y	N

<b>PERC Purchases</b>	
Date:	Date:
Gallons:	Gallons:

**December 2022**

Sunday	Monday	Tuesday	Wednesday	Thursday	Friday	Saturday
				1	2 <input type="checkbox"/> Temp logged <input type="checkbox"/> Inspect logged	3
4	5	6	7	8	9 <input type="checkbox"/> Temp logged <input type="checkbox"/> Inspect logged	10
11	12	13	14	15	16 <input type="checkbox"/> Temp logged <input type="checkbox"/> Inspect logged	17
18	19	20	21	22	23 <input type="checkbox"/> Temp logged <input type="checkbox"/> Inspect logged	24
25	26	27	28	29	30 <input type="checkbox"/> Temp logged <input type="checkbox"/> Inspect logged	31

## Lane Regional Air Protection Agency (LRAPA) Air Quality Contacts Lane County, Oregon:

**Kelly Conlon**, Permit Writer

Phone: 541-736-1056 ext. 234

Email: [kelly@lrapa.org](mailto:kelly@lrapa.org)

**Robbye Robinson**, Document Coordinator

Phone: 541-736-1056 ext. 214

Email: [robbye@lrapa.org](mailto:robbye@lrapa.org)

**LRAPA Website:** [www.lrapa.org](http://www.lrapa.org)

Documents can be provided upon request in an alternate format for individuals with disabilities or in a language other than English for people with limited English skills. To request a document in another format or language, call LRAPA at 541-736-1056, or toll-free at 1-877-285-7272; or email [permitting@lrapa.org](mailto:permitting@lrapa.org).

Email: <a href="mailto:drycleanerinfo@deq.state.or.us">drycleanerinfo@deq.state.or.us</a>	Phone: <b>1-800-452-4011 (in Oregon)</b>
Website: <a href="http://www.oregon.gov/deq/Hazards-and-Cleanup/Pages/Dry-Cleaner.aspx">www.oregon.gov/deq/Hazards-and-Cleanup/Pages/Dry-Cleaner.aspx</a>	

Other contacts and DEQ information:

### Emergency Spill Contacts

#### Oregon Emergency Response System

Call for Perc releases, leaks or spills more than 1 cup.

**1-800-452-0311**

### Dry Cleaning Machine Service Providers

<b>Arent Machinery Co.</b>	Jay-Dee Arent	503 657-3000	<a href="mailto:arentmach@arentmachinery.com">arentmach@arentmachinery.com</a>	CCB# 79174
<b>Best Equipment Co.</b>	Chong Kim	971-219-2255	<a href="mailto:bestchongkim@gmail.com">bestchongkim@gmail.com</a>	CCB# 100846
<b>HD-Machinery</b>	Chris J. Kim	503 997-5441	<a href="mailto:uml125@hanmail.net">uml125@hanmail.net</a>	CCB# 176823
<b>Peterson Equip Co.</b>	Russell Peterson	503-981-4032	<a href="mailto:russell@peterson-eq.com">russell@peterson-eq.com</a>	CCB# 84500